

Model:

Class:

BGS110DA11XX

Uniblock GS

Technical data

Characteristics	M.U.	Value
Working temperature	°C	-15 ÷ -25
Starting mode		Direct
Voltage	Volt-Ph-Hz	230/1/50
Rated input	kW*	0,50
Rated input	Amp*	3,20
Peak current	Amp	24,0
Max current	Amp	7,1
Refrigerant		R452A
	GWP	2140
Defrost		Electric
Defrost heaters	watt	450
Condensing unit mass	Kg	46
Evaporator mass	Kg	13

Compressor

Type		Hermetic
Nominal power	kW	0,74

Condenser

Air flow	m³/h	600
----------	------	-----

Evaporator

Air flow	m³/h	600
Air throw	m**	4

PED Category		0
--------------	--	---



Power data

Tc °C	Ta °C	P watt	P Kcal/h	V120 m³	V100 m³	V80 m³
	20	937	806	5,7	5,1	4,4
	25	882	759	5,1	4,5	4
-15	30	827	711	4,6	4,1	3,6
	35	768	660	4	3,6	3,1
	40	701	603	3,4	3	2,7
	45	623	536	2,8	2,5	2,2
	20	782	673	4,1	3,6	3,2
	25	732	630	3,7	3,3	2,9
-20	30	679	584	3,2	2,8	2,5
	35	624	537	2,8	2,5	2,2
	40	570	490	2,4	2,1	1,9
	45	519	446	2	1,8	1,6
	20	630	542	2,8	2,5	2,2
	25	581	500	2,5	2,2	2
-25	30	539	464	2,2	2	1,7
	35	500	430	1,9	1,7	1,5
	40	460	396	1,6	1,4	1,2
	45	416	358	1,4	1,2	1,1

* When normally running: -20 ÷ +30°C

** Use air throw as a base. Air throw is affected by many factors such as height of room, product storage, location of evaporator, etc.

Tc: Coldroom temp. - Ta: External temp.

P: Refrigerant capacity - V: Recommended cold-room volume

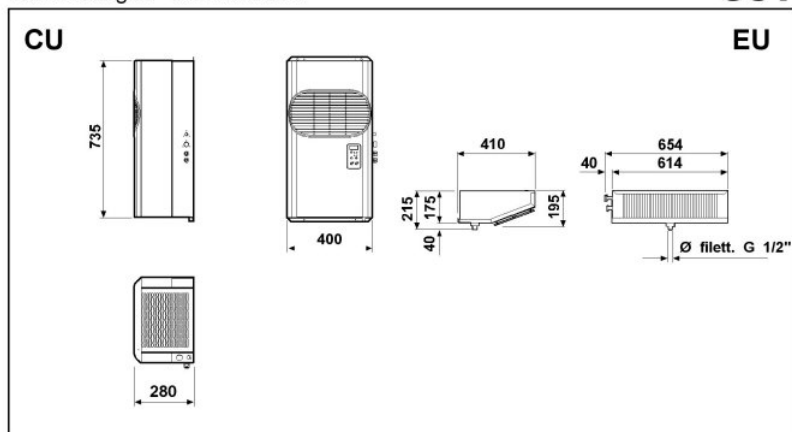



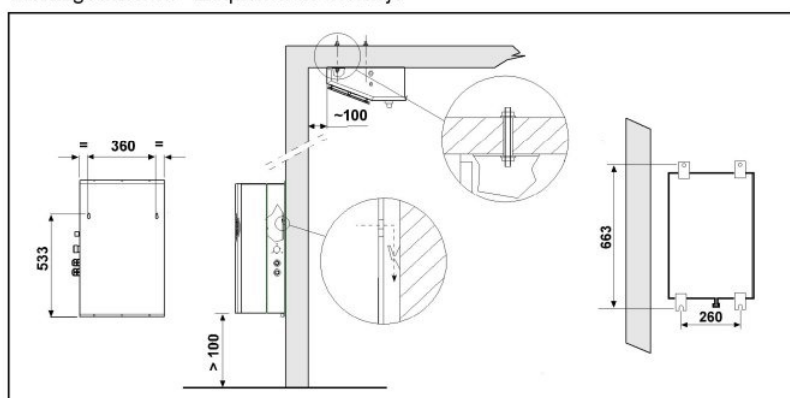



Schema di montaggio - Mounting scheme - Schema de montage
Montageschema - Esquema de montaje

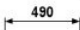
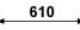

- * Raccomandazioni in sede di installazione e per il controllo fornite sul manuale di installazione
- * To be advised at time of order for factory installation and operating instructions
- * Recommendations au moments d'installations et pour le contrôle fournis sur le manuel d'installation
- * Empfehlungen für die Installationsphase und zur Kontrolle, die im Handbuch zur Installation enthalten sind
- * Por cuanto respecta a recomendaciones de instalación y control ver manual de instalación

Massa e misure imballi - Packing mass and dimensions - Masse et dimensions emballages
Verpackungsmasse und-abmessungen - Masa y medidas del embalaje

CU		EU		MASSA-MASS-MASA-MASSE-MASSE	
				11 Kg	
				VOLUME - VOLUME - VOLUME - VOLUMEN - VOLUMEN	0,28 m³
CU		EU		MASSA-MASS-MASA-MASSE-MASSE	
				1,5 Kg	
				VOLUME - VOLUME - VOLUME - VOLUMEN - VOLUMEN	0,10 m³